

GROUP 14

ENGINE COOLING

GENERAL

OUTLINE OF CHANGES

The following maintenance service procedures have been established to correspond to the addition of vehicles with 4G9-GDI engine. Maintenance service procedures not listed below are the same as before.

WATER HOSE AND WATER PIPE

REMOVAL AND INSTALLATION

Pre-removal and Post-installation Operation

- Engine Coolant Draining and Supplying
- Air Cleaner and Air Intake Hose Assembly Removal and Installation

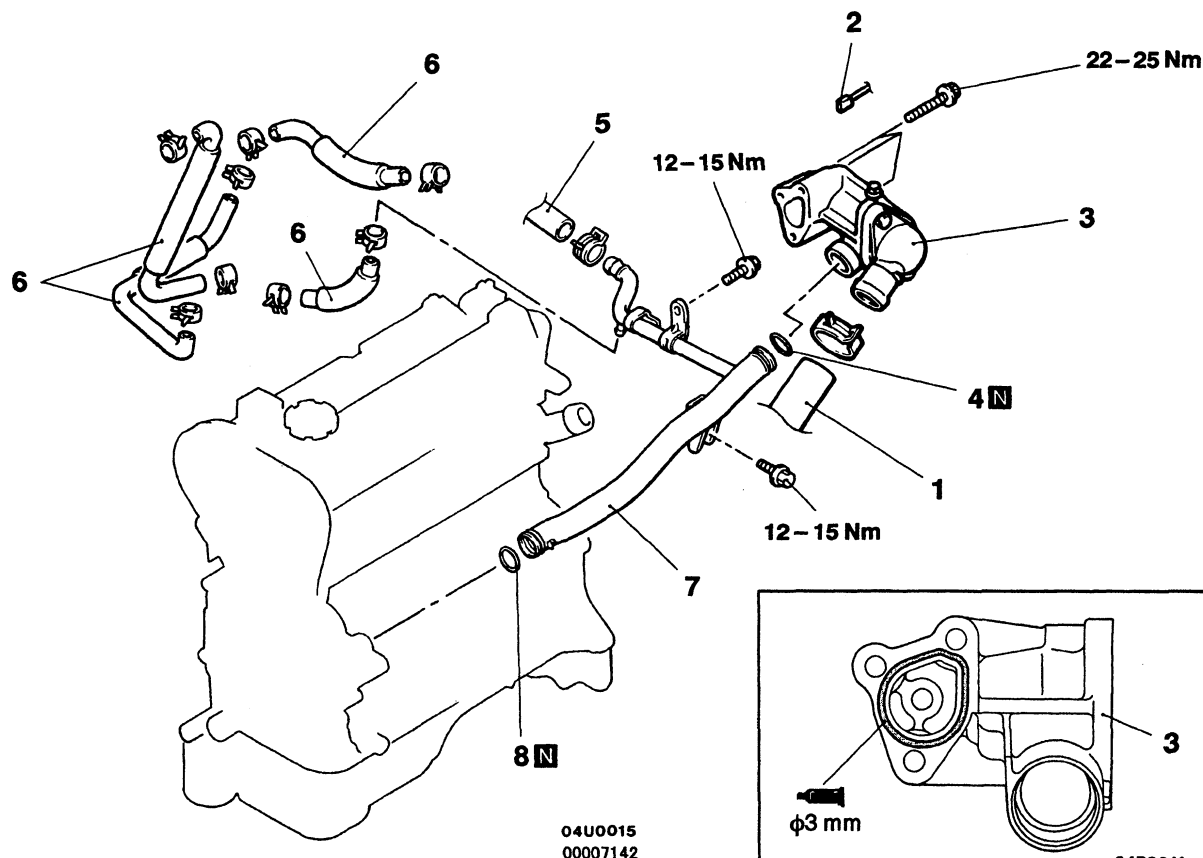
04U0015
00007142

04R0011

Sealant
Mitsubishi Genuine Part No.
MD970389 or equivalent

Removal steps

◀A▶ ▶C▶

1. Radiator lower hose connection
 2. Engine coolant temperature gauge unit connector
 3. Thermostat case assembly
 4. O-ring
 5. Heater hose connection
- Intake manifold (Refer to GROUP 15.)

▶B▶
▶A▶

6. Water hose
7. Water inlet pipe assembly
8. O-ring

▶A▶

NOTE

Removal and installation service points are the same as before.